

patersongroup

Geotechnical
Engineering

Environmental
Engineering

Hydrogeology

Geological
Engineering

Materials Testing

Building Science

Archaeological
Services

Environmental Site Remediation Program
37 Cumberland Street
Cornwall, Ontario

Prepared For

J.F. Markell Homes Limited

Paterson Group Inc.

Consulting Engineers
154 Colonnade Road South
Ottawa (Nepean), Ontario
Canada K2E 7J5

Tel: (613) 226-7381

Fax: (613) 226-6344

www.patersongroup.ca

January 31, 2013⁴

Report: PE3050-1

Table of Contents

EXECUTIVE SUMMARY	ii
1.0 INTRODUCTION	1
1.1 Background	1
2.0 SOIL REMEDIATION PROGRAM	2
3.0 CONFIRMATORY SAMPLING AND ANALYSIS	2
3.1 Confirmatory Soil Sampling Program	2
3.3 Analytical Testing	3
3.4 Quality Assurance/Quality Control	6
4.0 ASSESSMENT AND CONCLUSIONS	6
4.1 Assessment	6
4.2 Conclusion	7
5.0 STATEMENT OF LIMITATIONS	7

List of Figures

Figure 1 – Key Plan
Drawing PE3050-3 – Site Remediation Plan

List of Appendices

Appendix 1 Laboratory Certificates of Analysis
Weigh Scale Summary

EXECUTIVE SUMMARY

Assessment

Paterson Group monitored the remediation excavation of contaminated fill at 37 Cumberland Street in the City of Cornwall, Ontario. The contaminated soil had been identified by a Phase II ESA conducted by Paterson, at the subject site. Paterson was responsible for the segregation of contaminated and non-contaminated soil using visual screening methods and analytical testing. The impacted fill material consisted of a layer clearly distinct from the underlying native glacial till. The fill had a dark colouration and loose consistency, while the glacial till was dense and light coloured.

The excavated area was located along the front of the building (adjacent Cumberland Street) located at the subject property. The excavation terminated at depths ranging between 0.4 and 1.2 m below surrounding grade, and was terminated in dense glacial till. The excavation was bound by the building foundation to the east, and the property line to the west, while the north and south walls of the excavation were terminated where soil was found to comply with the selected site standards. Approximately 127 metric tonnes were removed from the property, and disposed of at the Cornwall landfill.

Analytical test results indicate that all confirmatory samples, collected from the glacial till, are in compliance with the selected MOE Table 3 standards. Furthermore, based on these results, the glacial till does not indicate any signs of potential leaching to have occurred. No groundwater was encountered in the excavation, however, water samples (collected as part of the Phase II-ESA) from a groundwater monitoring well located within the footprint of the excavated area did not indicate any exceedances of heavy metals when compared to the MOE Table 3 standards.

Conclusion

Based on our field observations combined with the analytical test results, in our opinion, all contaminated soil identified during the Phase II-ESA of 37 Cumberland Street, has been removed. No further remedial work is recommended at this time.

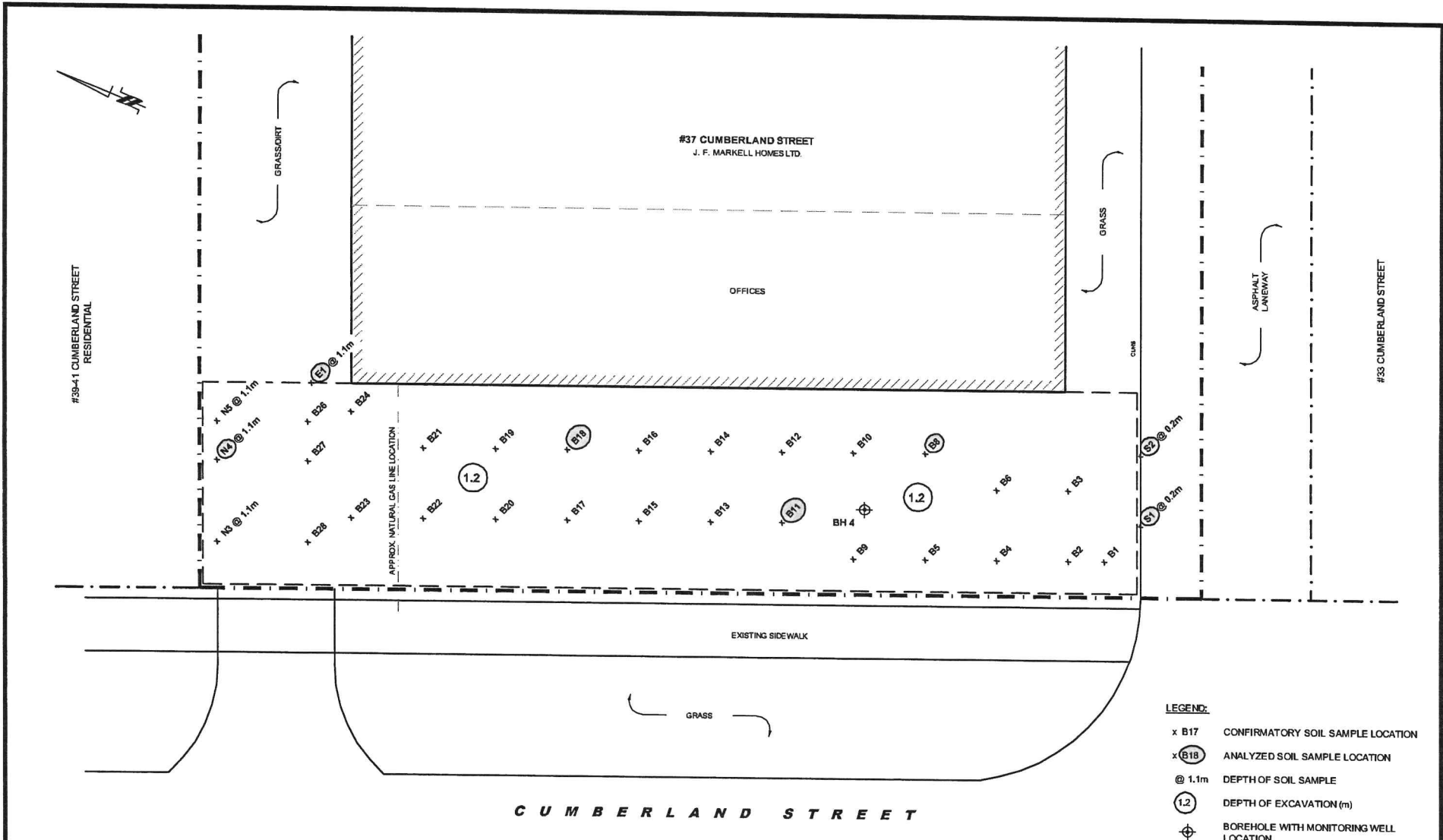

- LEGEND:**
- x B17 CONFIRMATORY SOIL SAMPLE LOCATION
 - x (B18) ANALYZED SOIL SAMPLE LOCATION
 - @ 1.1m DEPTH OF SOIL SAMPLE
 - (1.2) DEPTH OF EXCAVATION (m)
 - ⊕ BOREHOLE WITH MONITORING WELL LOCATION

patersongroup
 consulting engineers
 154 Colonnade Road South, Ottawa, Ontario K2E 7J5

Scale: 1:100
 Des.: AM
 Dwn: BA
 Chkd: MSD

J.F. MARKELL HOMES LIMITED
 SITE REMEDIATION
 37 CUMBERLAND STREET
 CORNWALL, ONTARIO

SAMPLING LOCATION PLAN

Dwg. No. **PE3050-3**
 Report No. PE3050-1
 Date: 01/2014